

# Comune di GROPPARELLO (PC)

## P.R.G. variante generale

Adozione : deliberazione del Consiglio Comunale n°            del  
Approvazione: deliberazione della Giunta Regionale n°        del  
Controdeduzioni:

### DISCIPLINA PARTICOLAREGGIATA ZONE "A"

Aggiornata alla Deliberazione della Giunta Provinciale n.366 del 4 Agosto 2005  
IL PROGETTISTA  
Dott. Arch. Gian Luca Fumi

P 19

-5 SET 2005

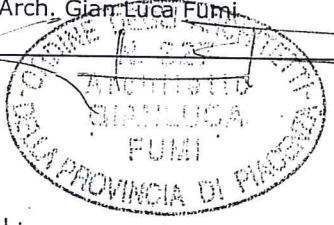

IL SINDACO  
Piazza Dott. Armando

dott.arch.  
DARIO BRICCHI



dott.arch.  
UGO GALUPPI

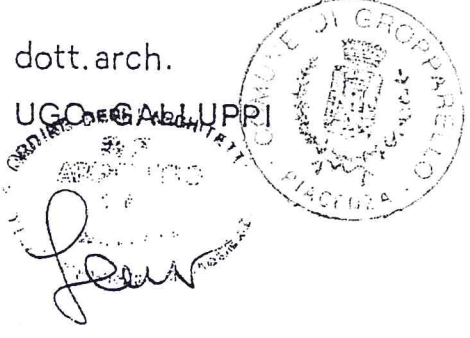

dott.arch.  
LUIGI GORRA



IL SINDACO

L' ASSESSORE ALL' URBANISTICA

IL SEGRETARIO

LEGENDA:

PRESCRIZIONI D'INTERVENTO:

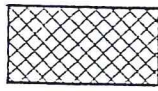

RESTAURO SCIENTIFICO

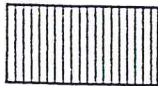

RESTAURO E RISANAMENTO CONSERVATIVO TIPO A

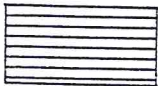

RESTAURO E RISANAMENTO CONSERVATIVO TIPO B

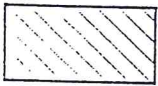

RIPRISTINO TIPOLOGICO

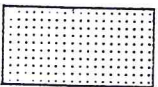

RECUPERO E RISANAMENTO AREE LIBERE

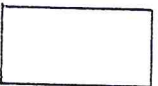

RISTRUTTURAZIONE EDILIZIA



RIPRISTINO EDILIZIO



DEMOLIZIONE SENZA RICOSTRUZIONE

DESTINAZIONI D'USO:



ATTREZZATURE RELIGIOSE

r

ABITAZIONI E FUNZIONI INTEGRATIVE DELLA RESIDENZA

a

ATTIVITA' CONNESSE ALLA FUNZIONE AGRICOLA  
COMPATIBILE CON LA RESIDENZA

v

VERDE PRIVATO



VIABILITA' STORICA TESTIMONIANZE RESIDUE

# GROPPARELLO (MARANO) AT

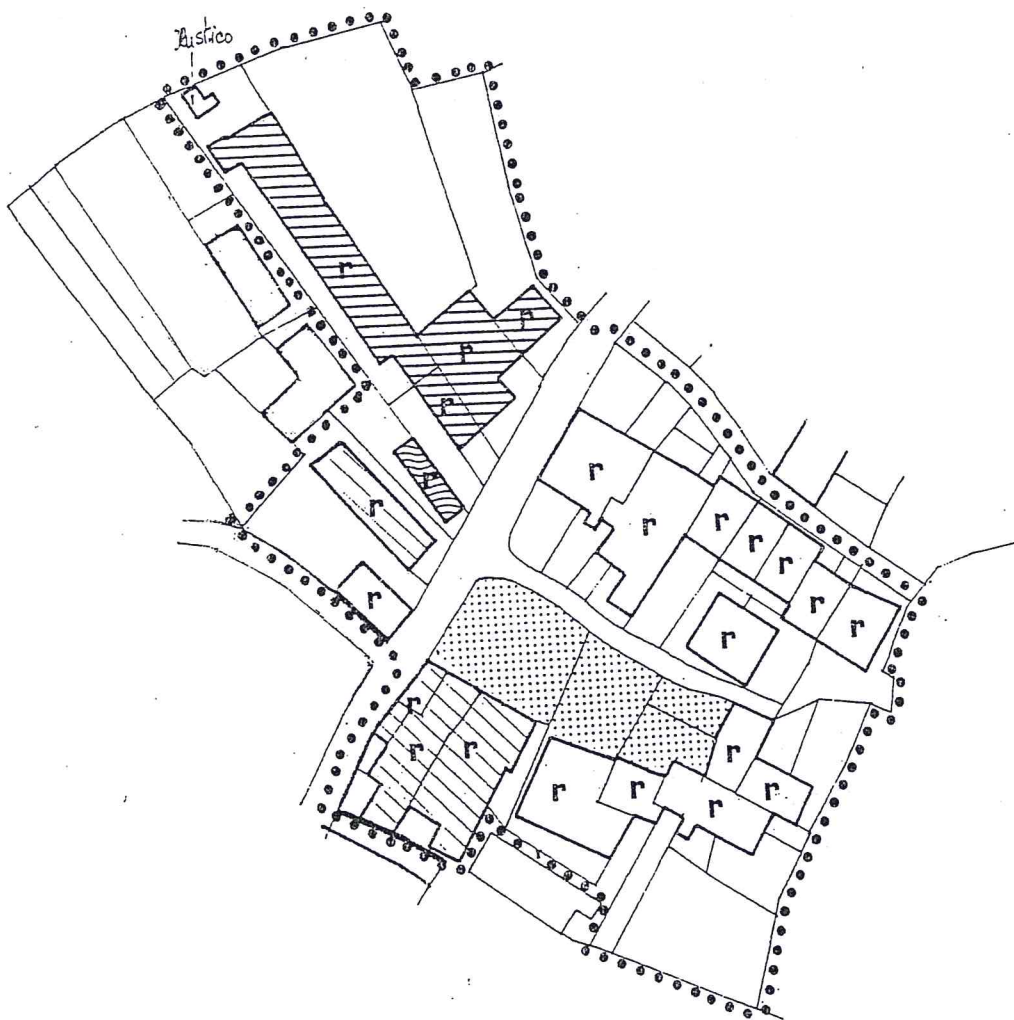

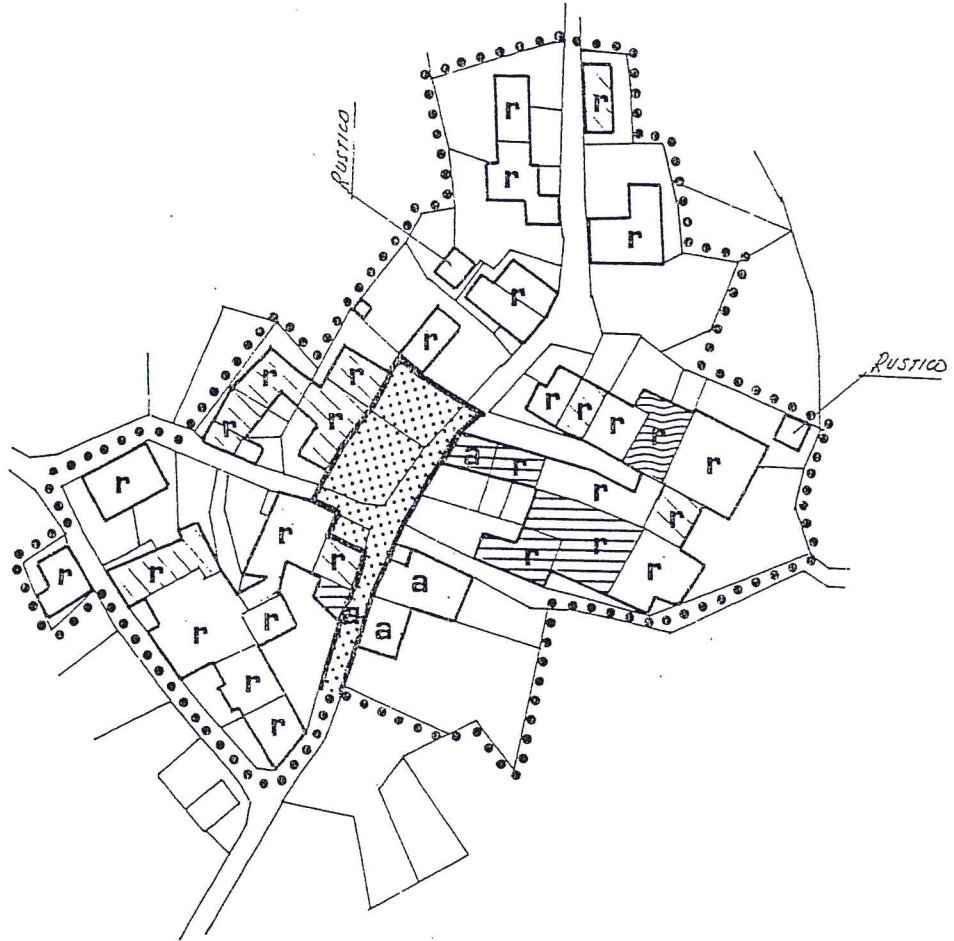

**GELATI A2**

# GEIATI - CHIESA VECCHIA A3

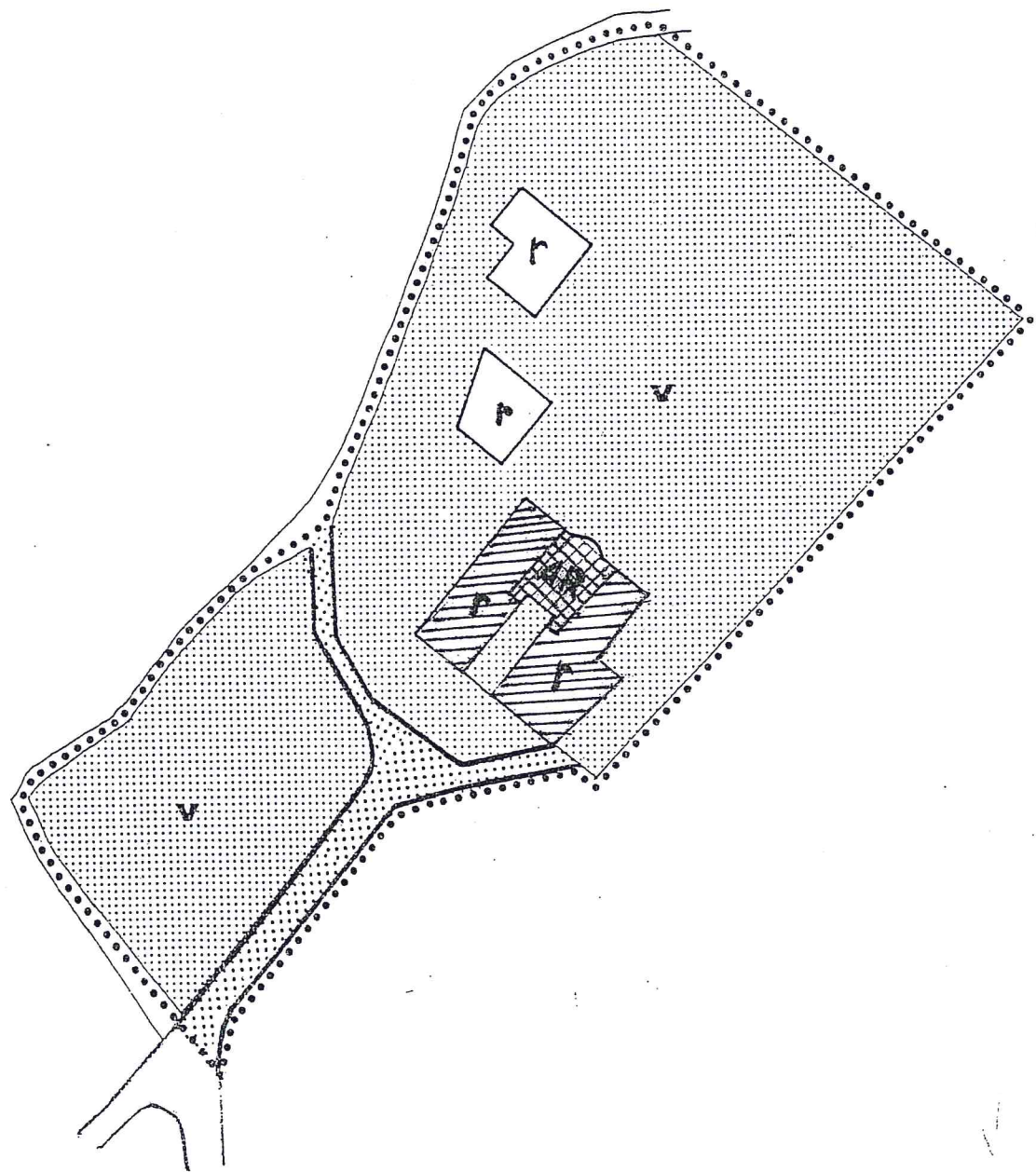

# CA' MONTI A4

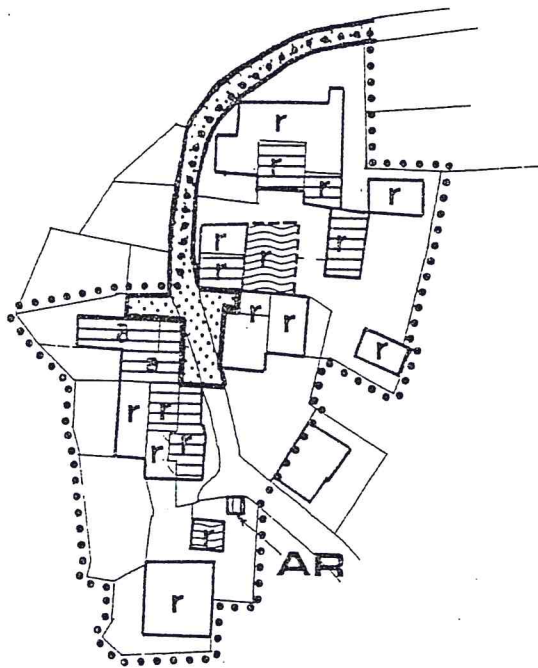

# GROPPARELLO - IL CASTELLO - A5

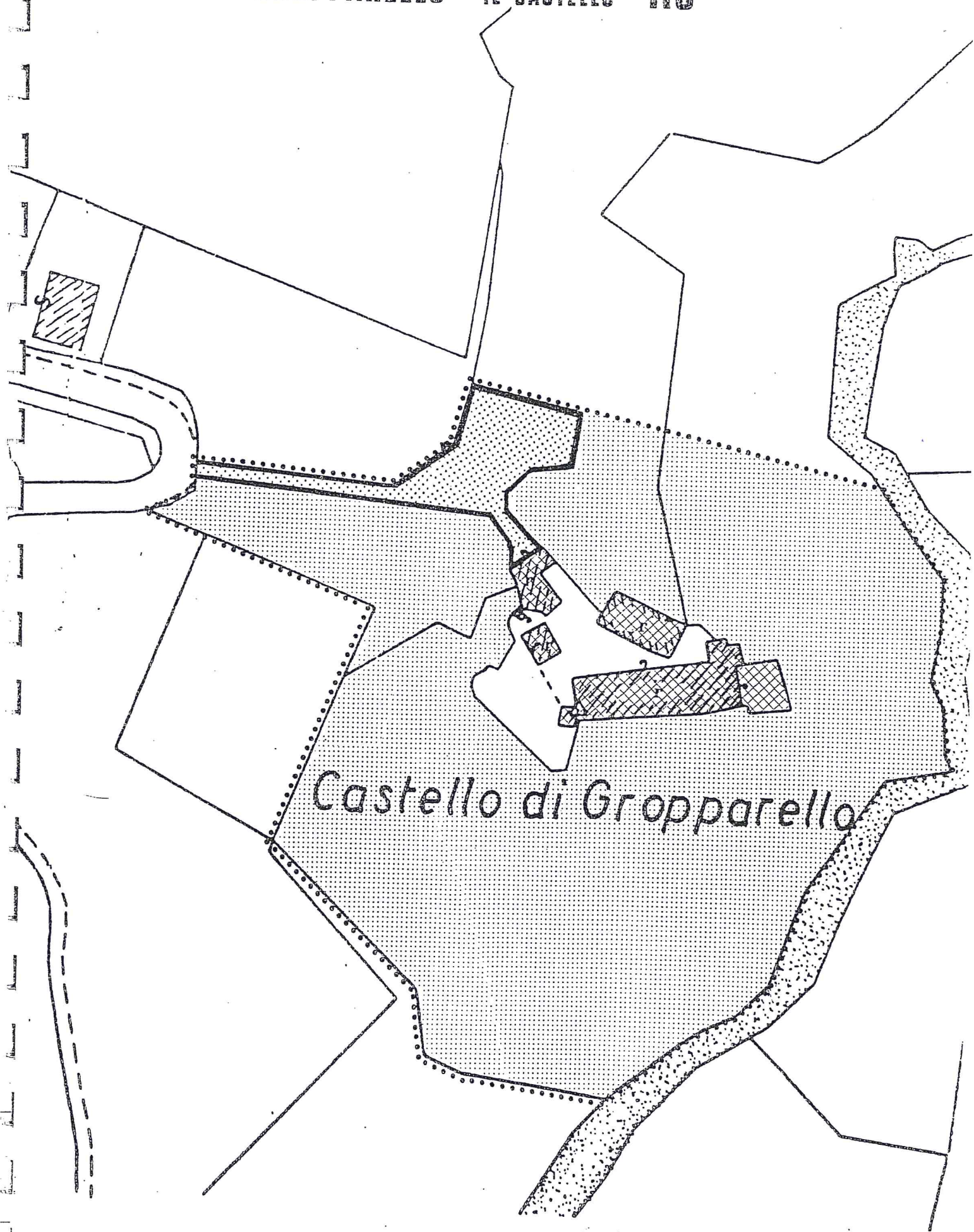

# ESPIONISIMO

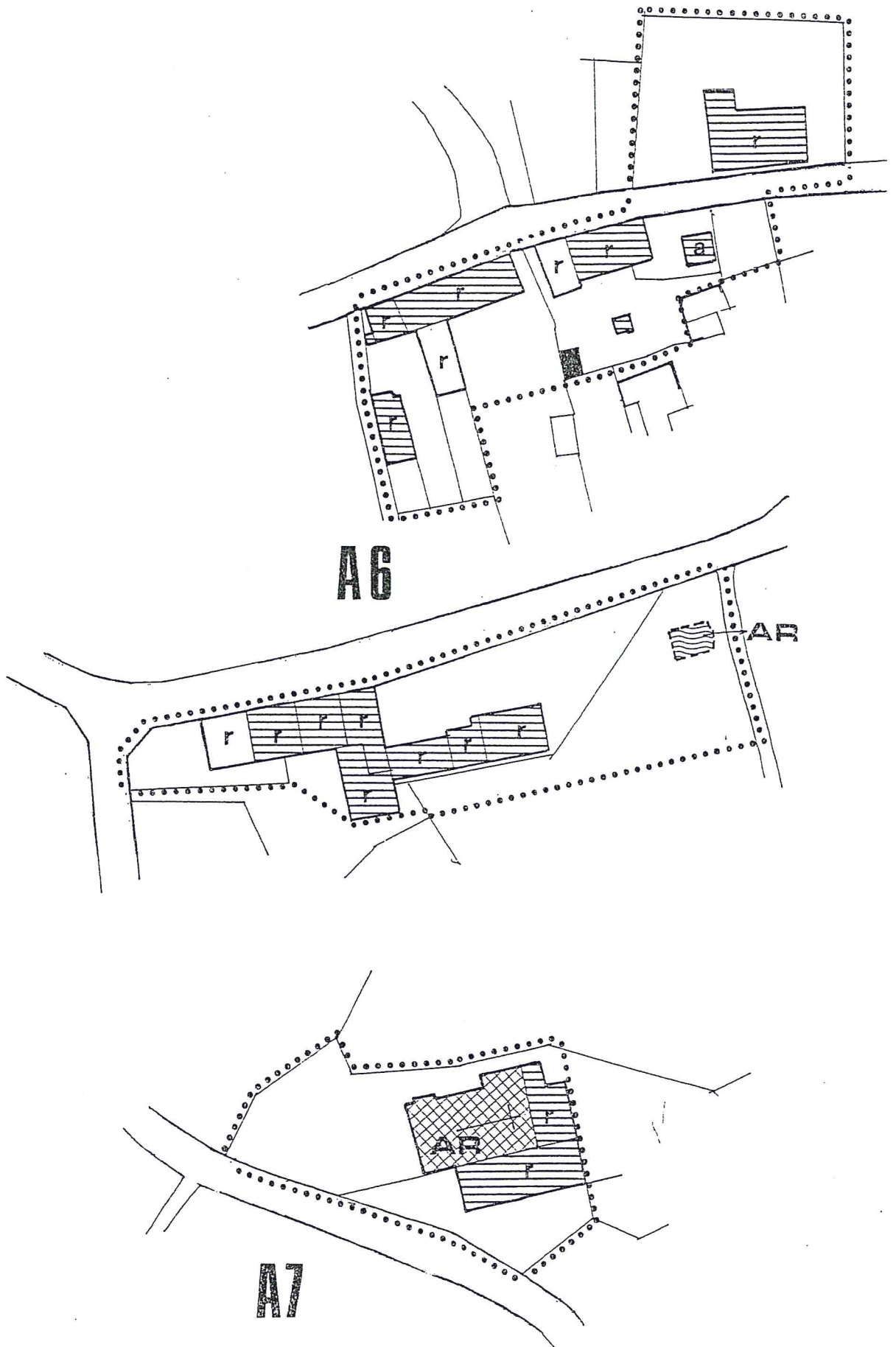



**MONTAFANO**

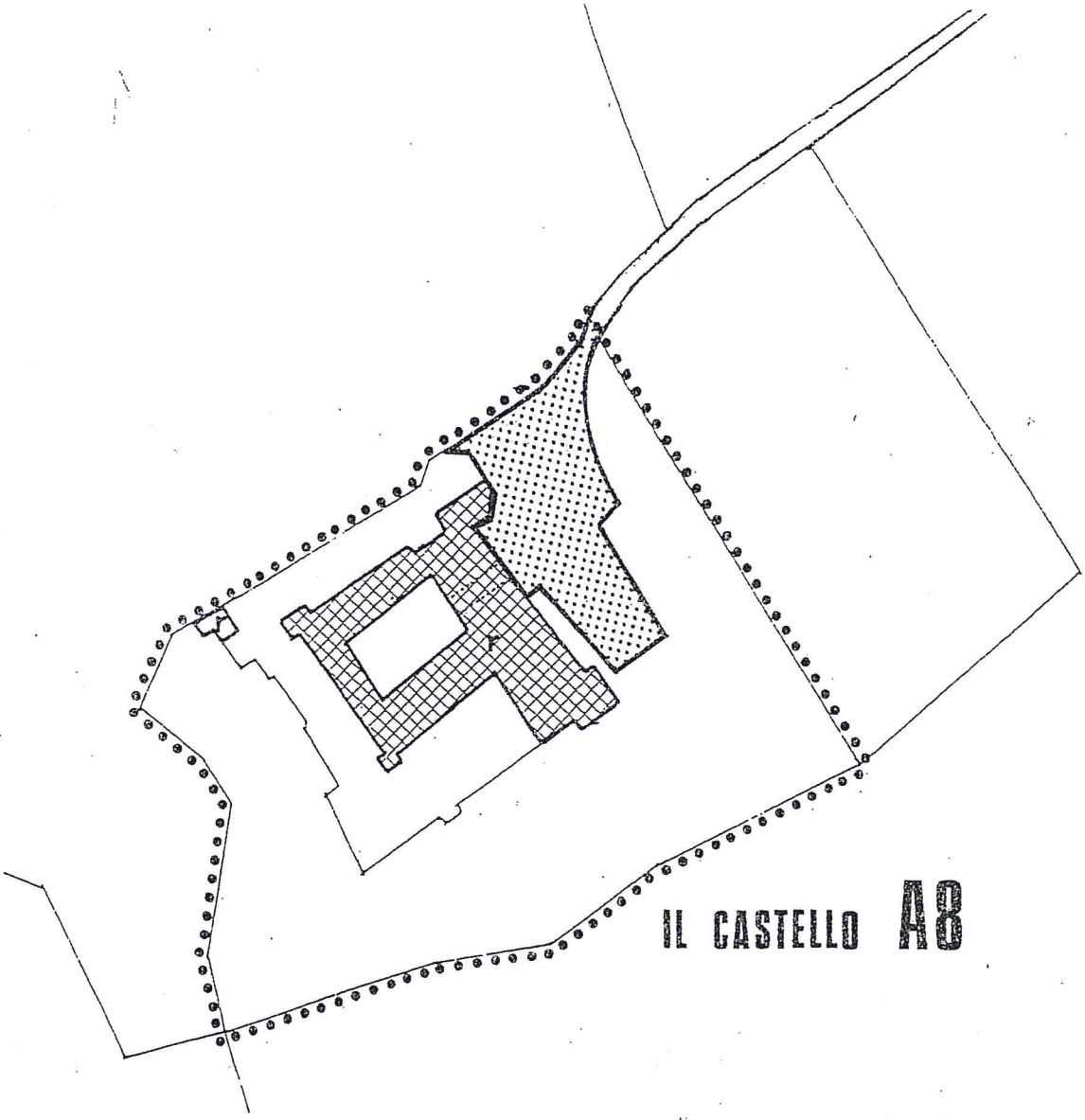

**IL CASTELLO A8**

**LA CHIESA A9**

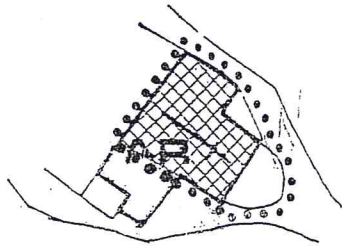

# CUSANO

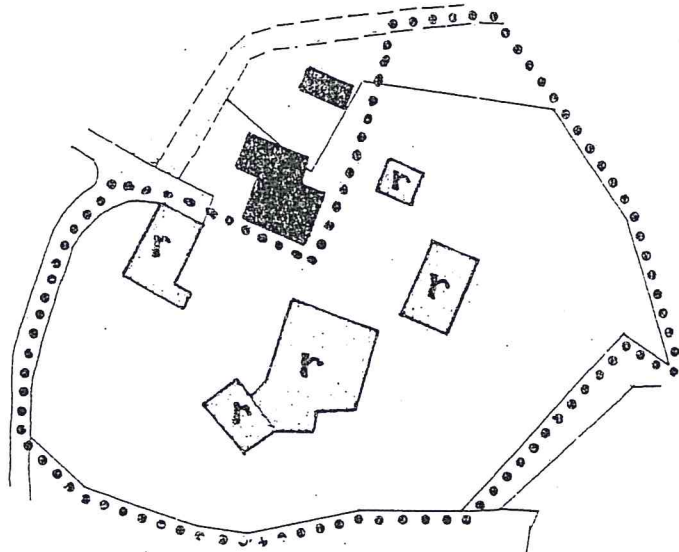

IL CASTELLO DEI ROSSI A 10

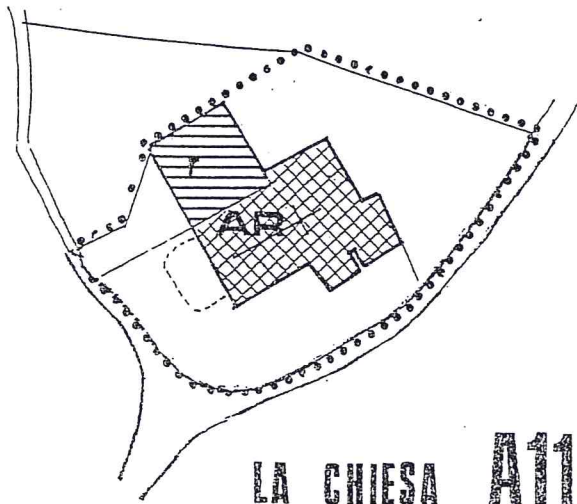

LA CHIESA A 11

Impianto tecnologico  
(addolcitore acquedotto)

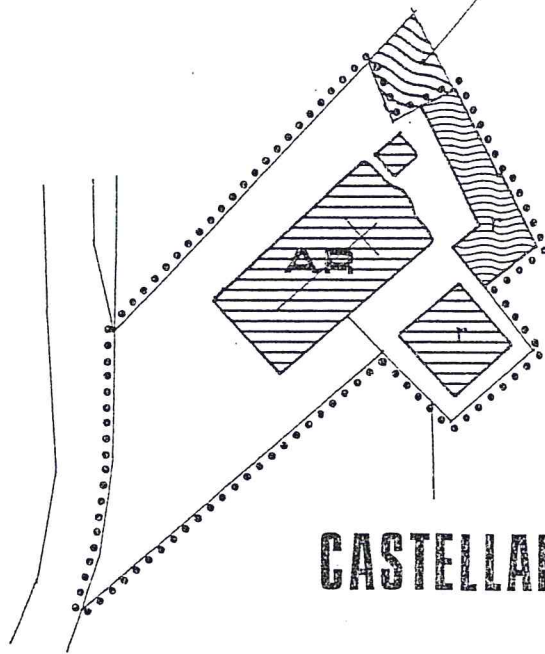

**CASTELLANA A12**

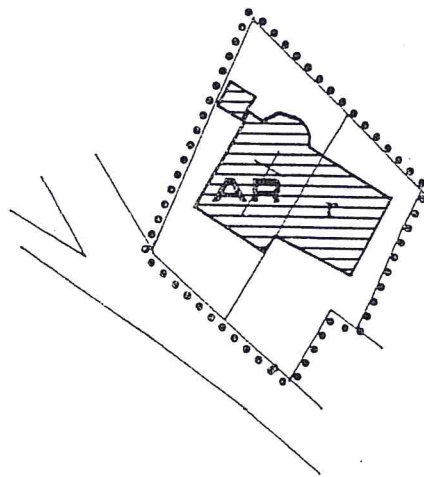

**OBOLO A13**

# GROUND PLAN

## A14

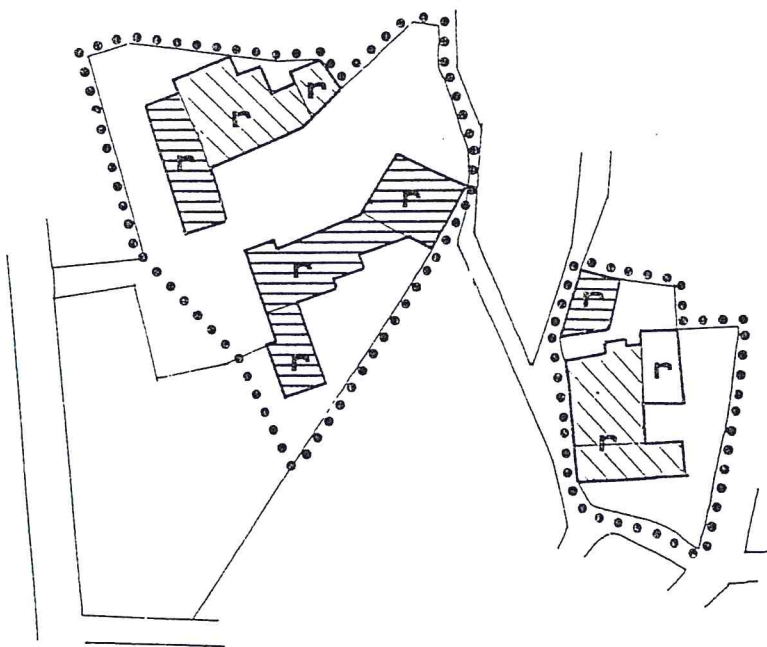

# PLAN OF THE CHURCH

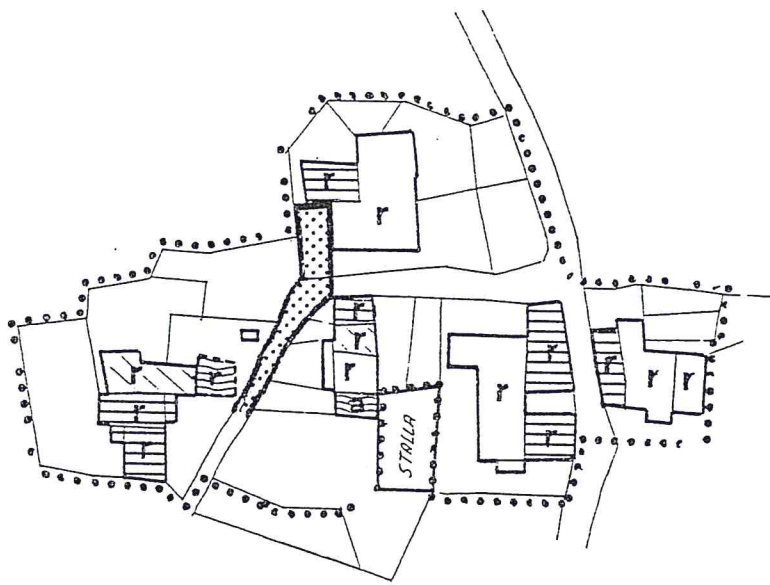

# VALESSO A16

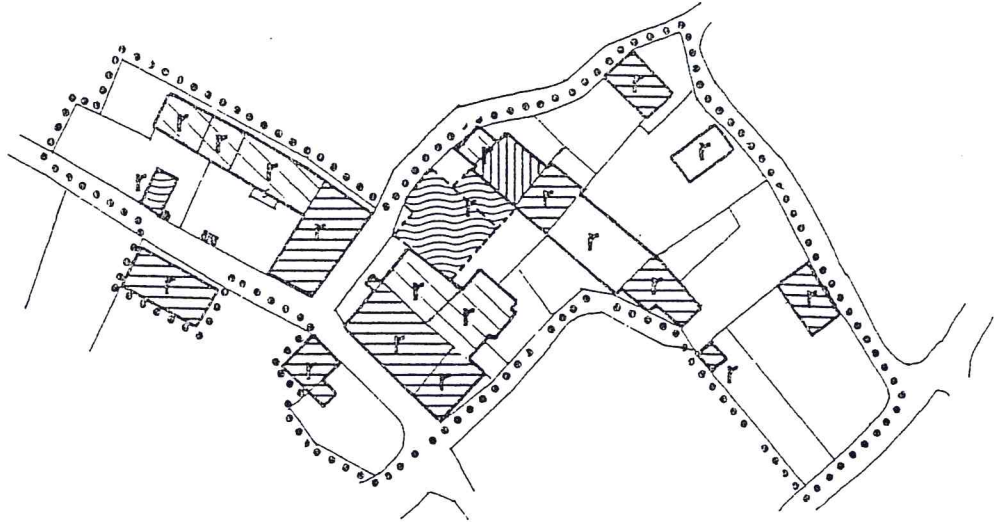

CA' SAMMI

A17

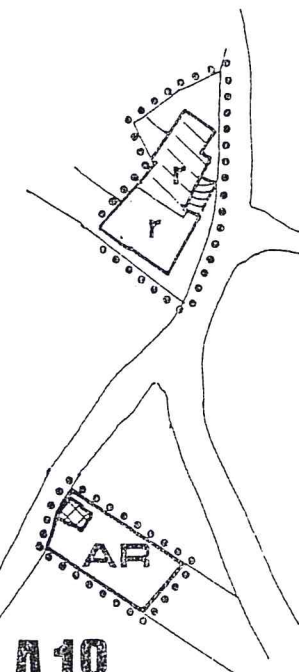

A18

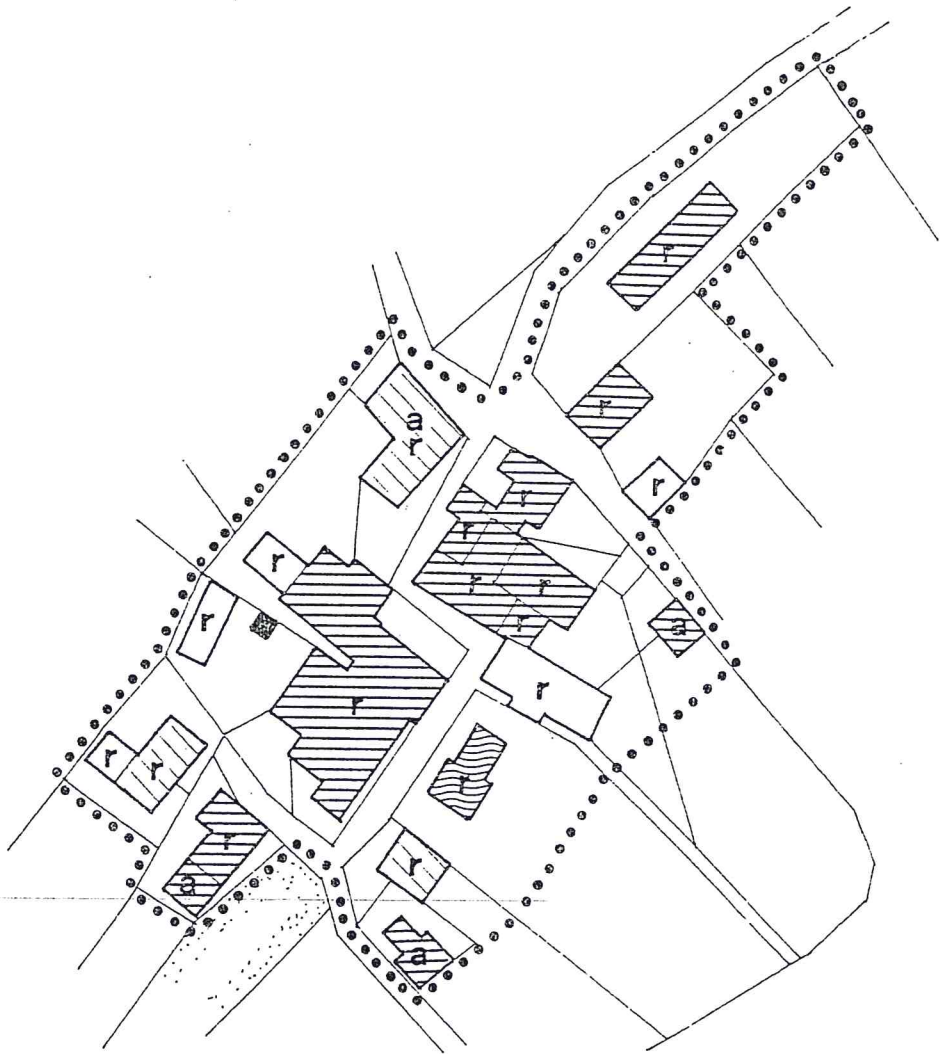

PIERFRANCESCO A 19

# CARINI DI OBOLLO A 20

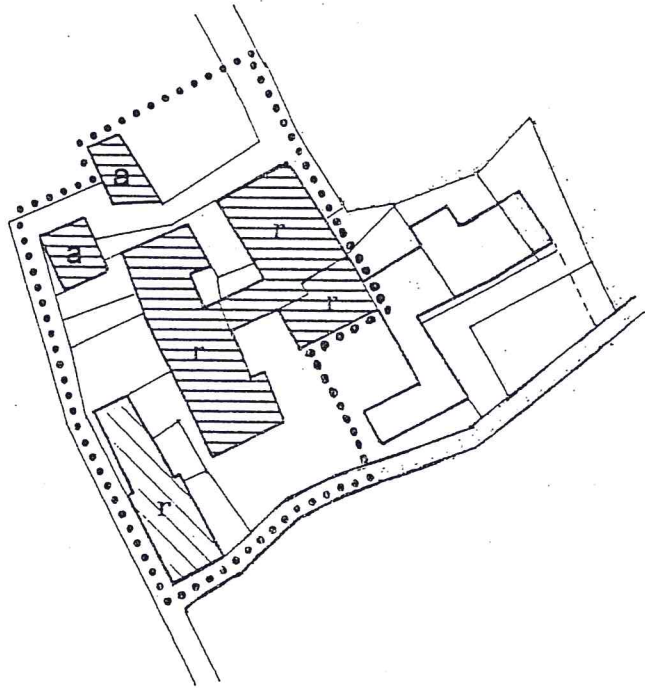



ARSO ARSO ARSO ARSO

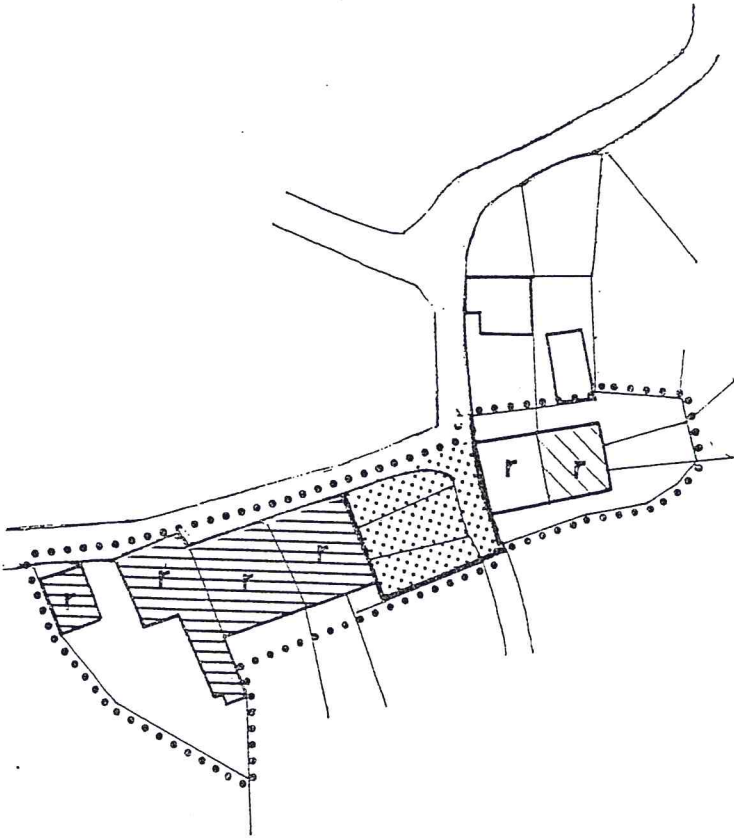

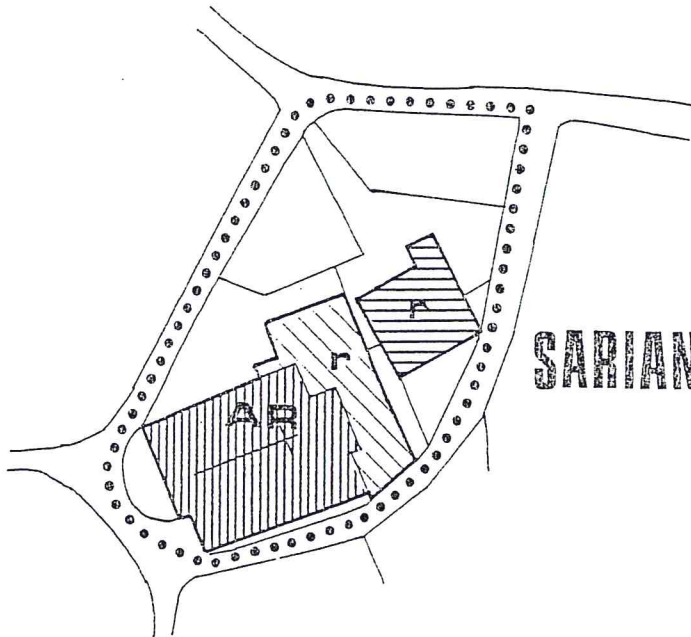

**SARIANO-LA CHIESA A22**

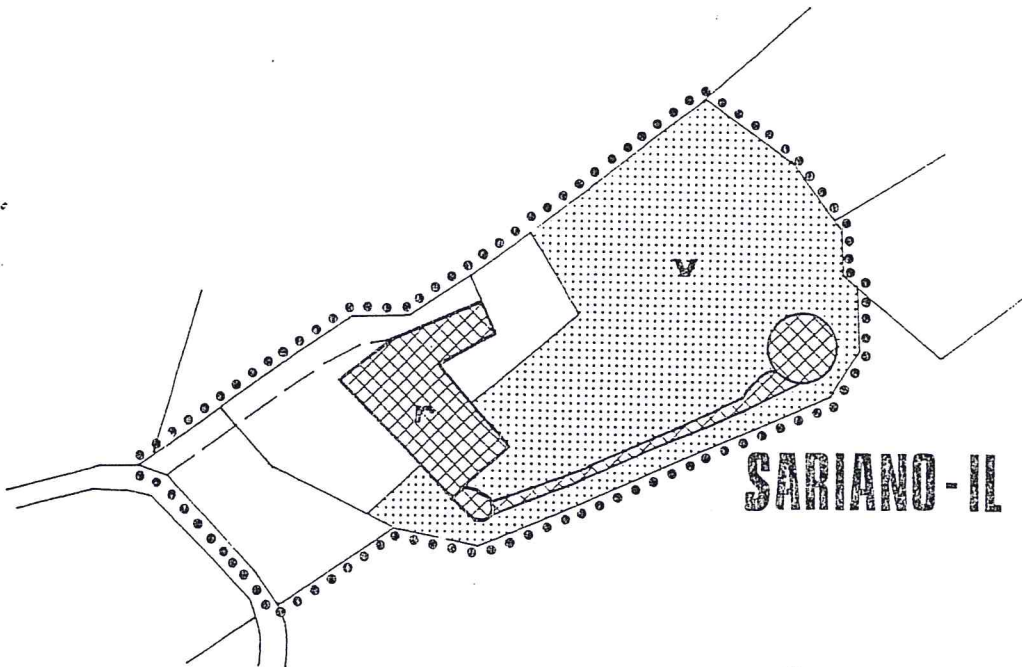

**SARIANO-IL CASTELLO A23**

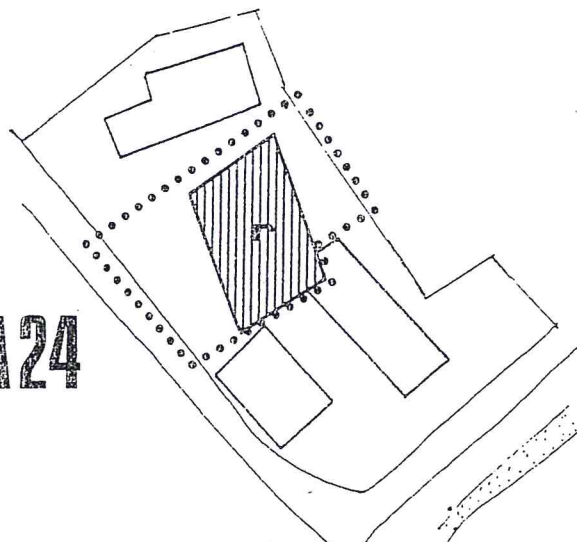

**COLOMBARA A24**

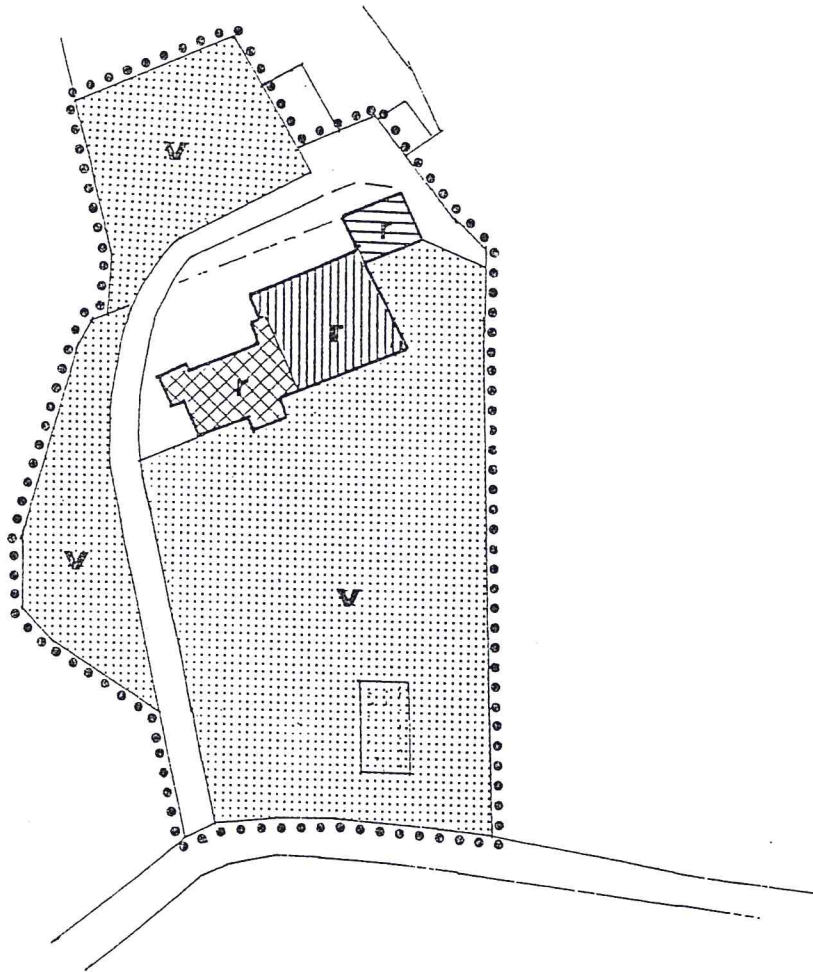

**TERRE GRAGNANA A 25**

# TAVASCA A 26

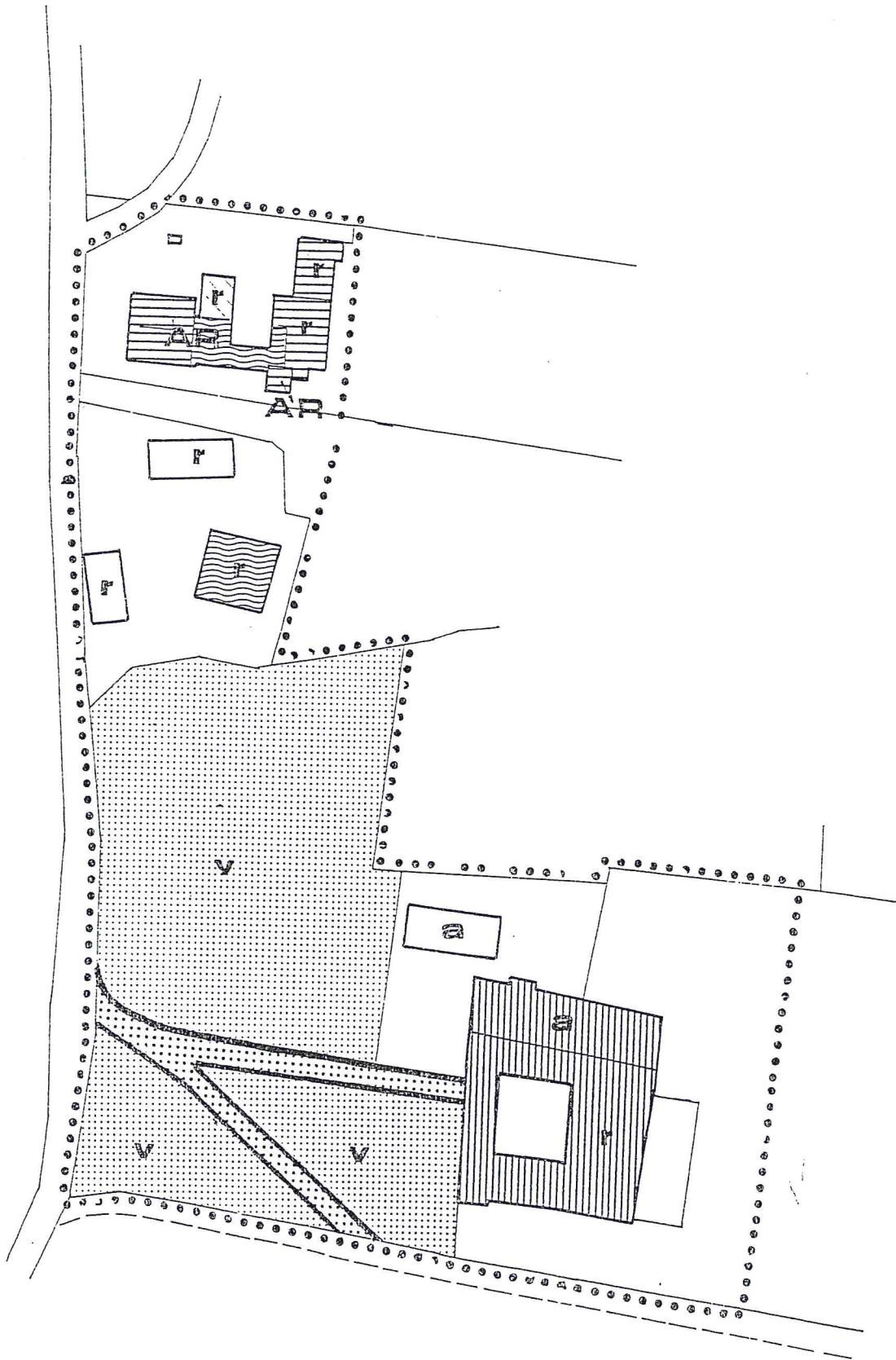

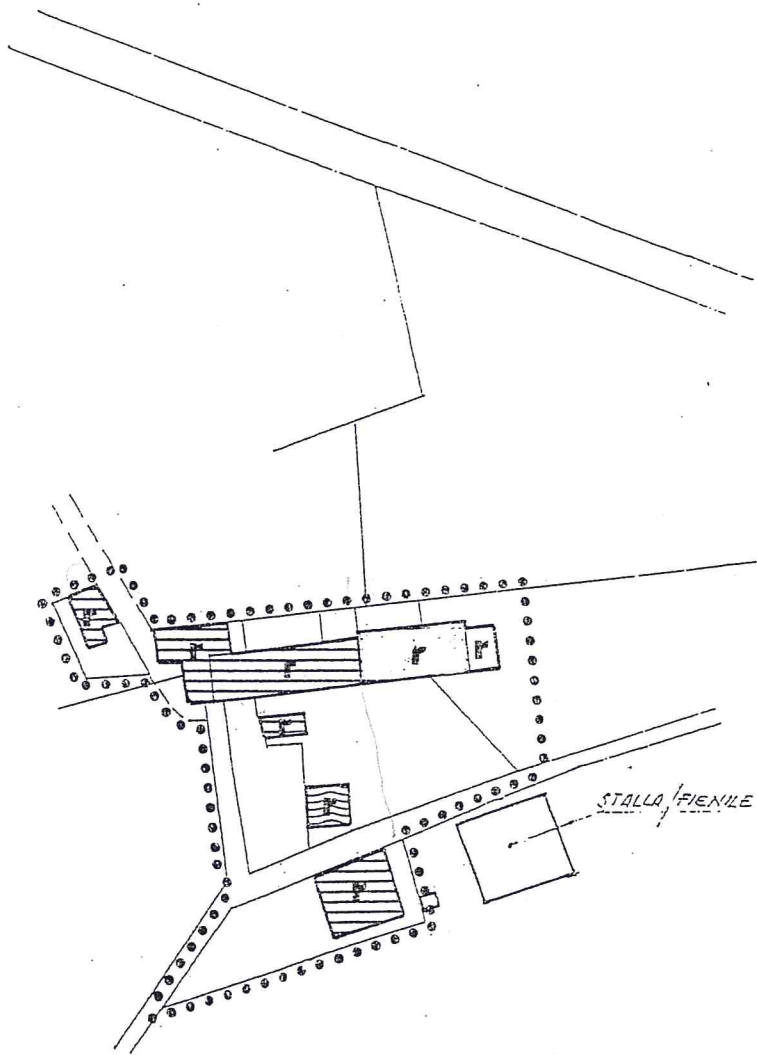

STALLA FIENILE DI RECENTE COSTRUZIONE

ALBERGO A27

PLAN 28

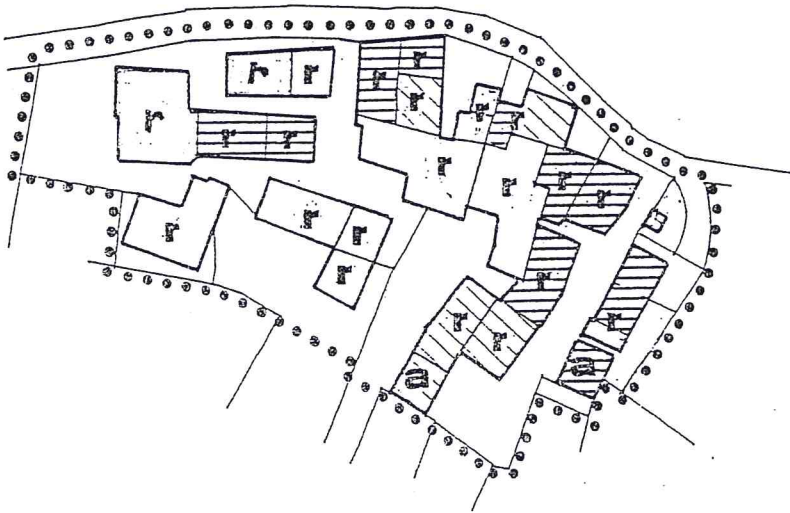

# PLAN 20

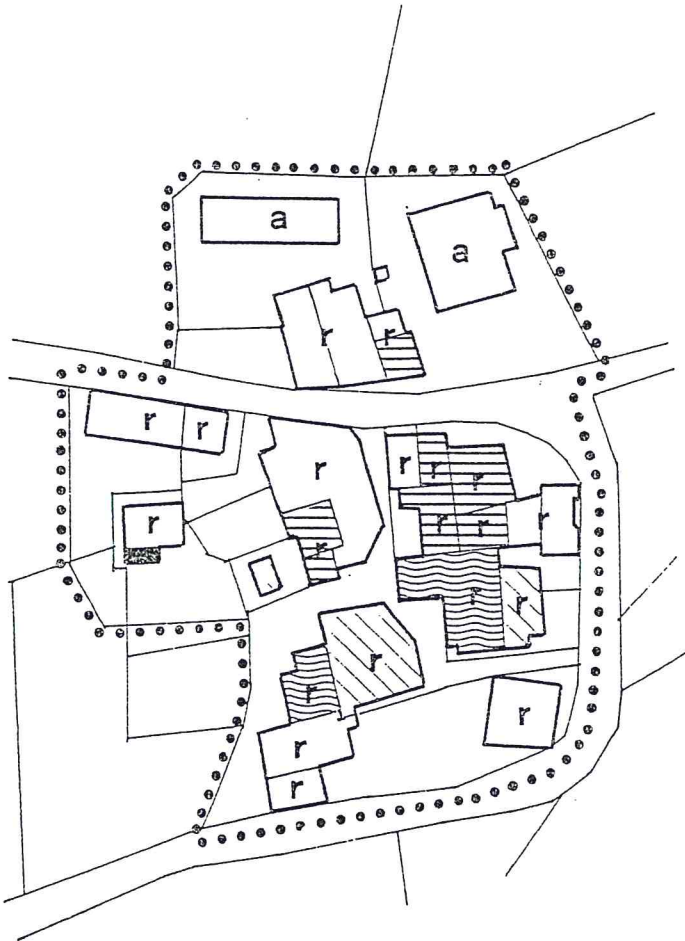

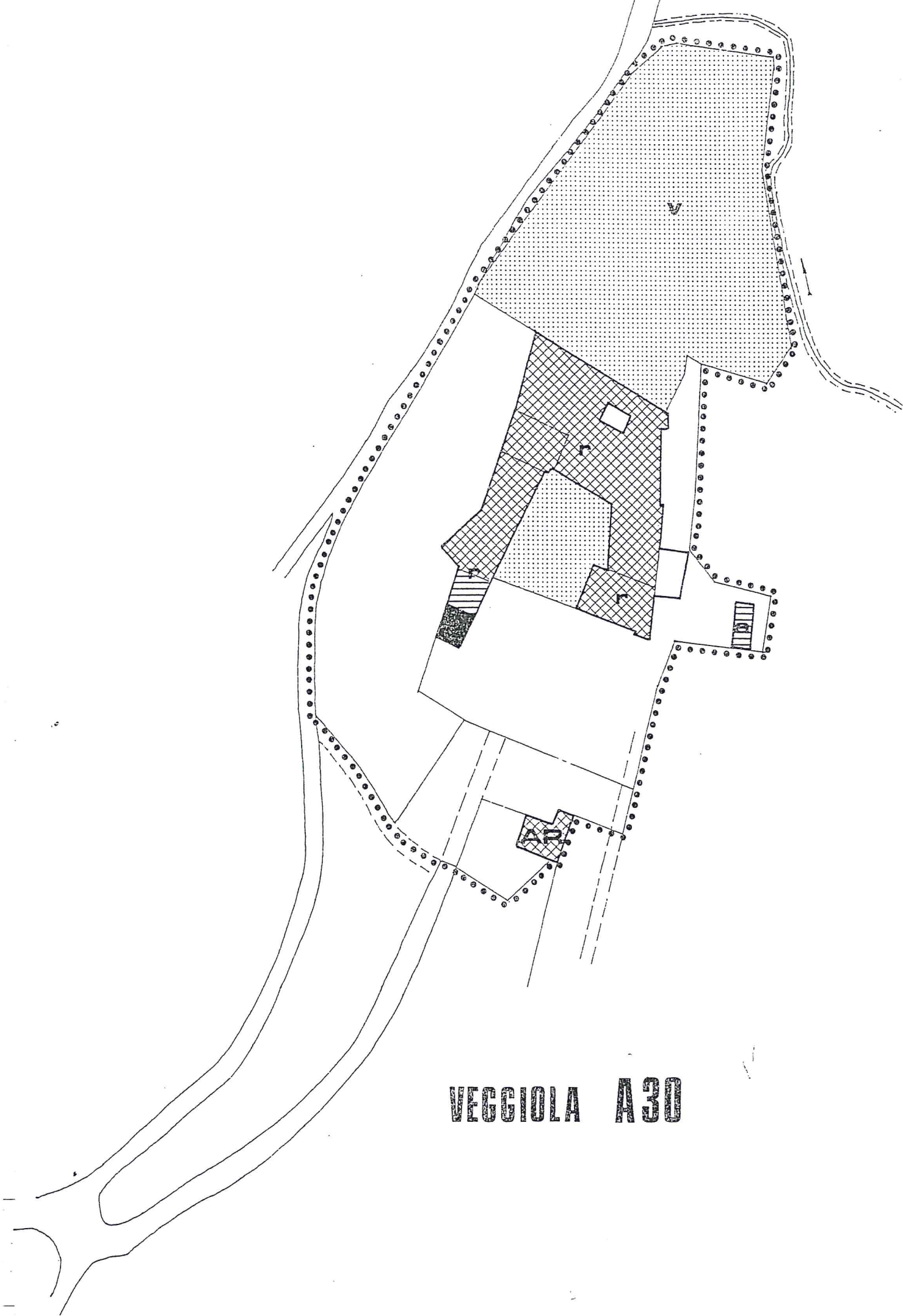

VEGGIO A 30



# CHIESUOLA A 31

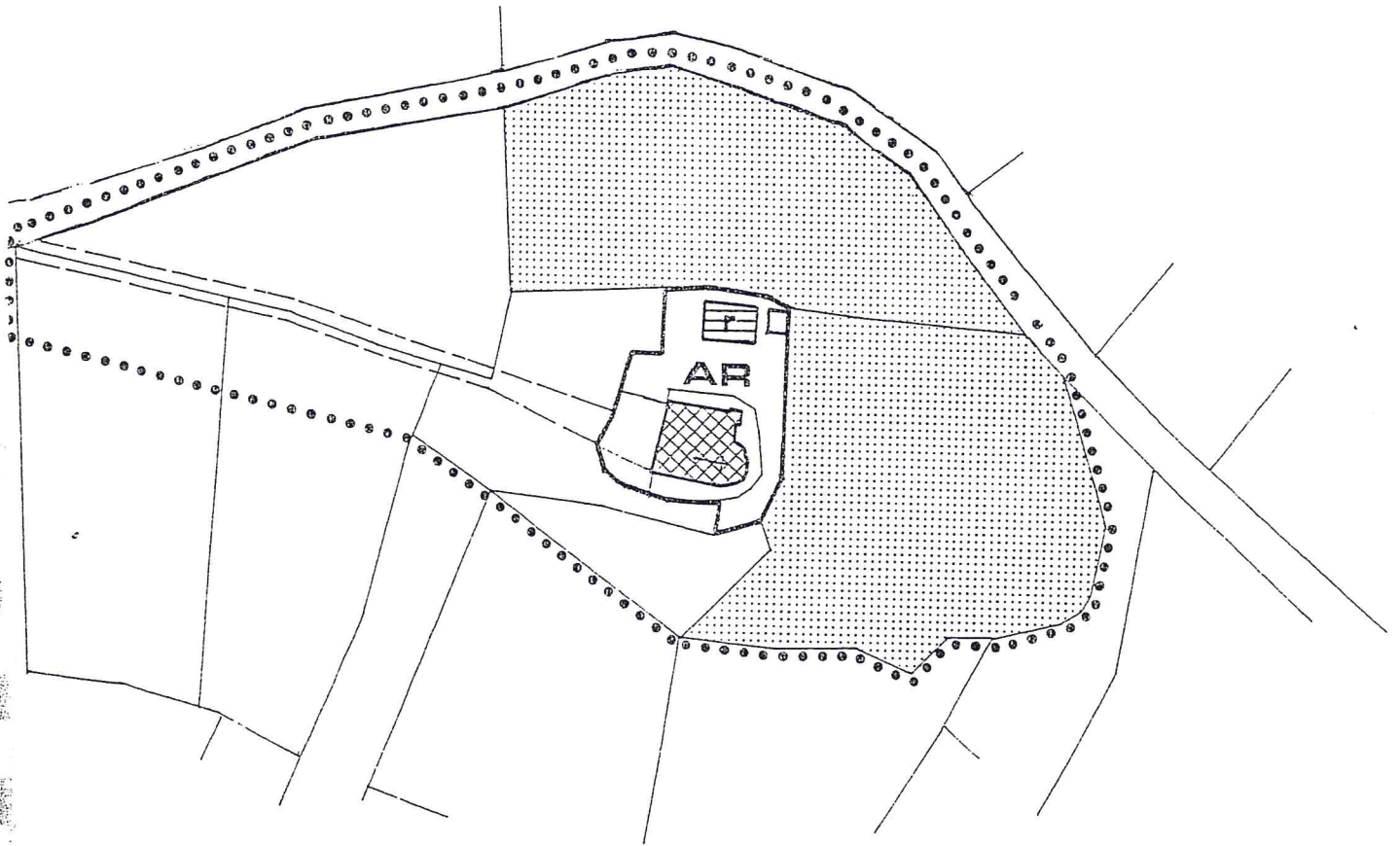

# I RIMONDI A32

